

# AP Godai - SECTION

Design & Drawing by: Tony Roehling



---

# ON BC - STOL WING - VERSION 1.0 (20

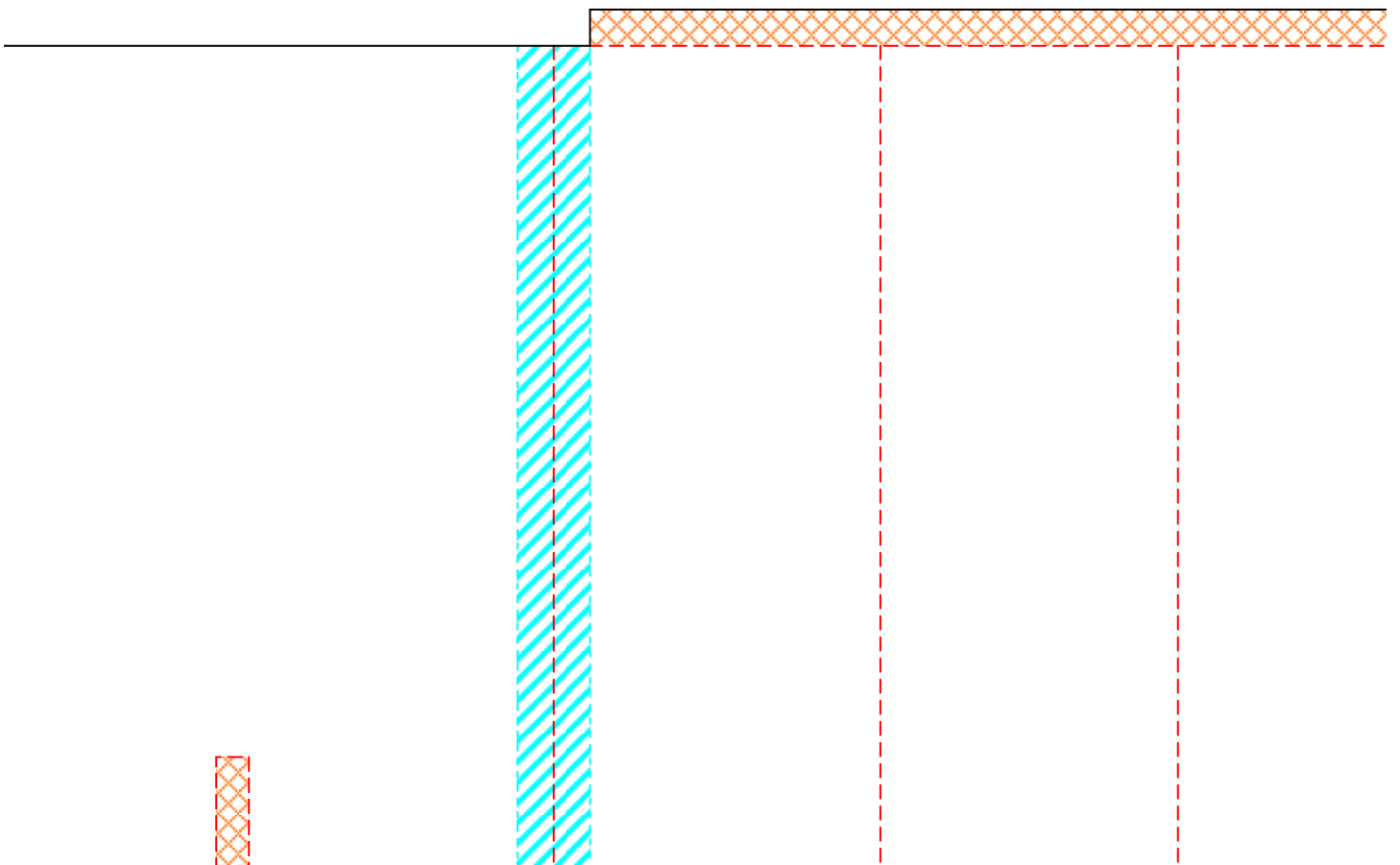

17-08-18)

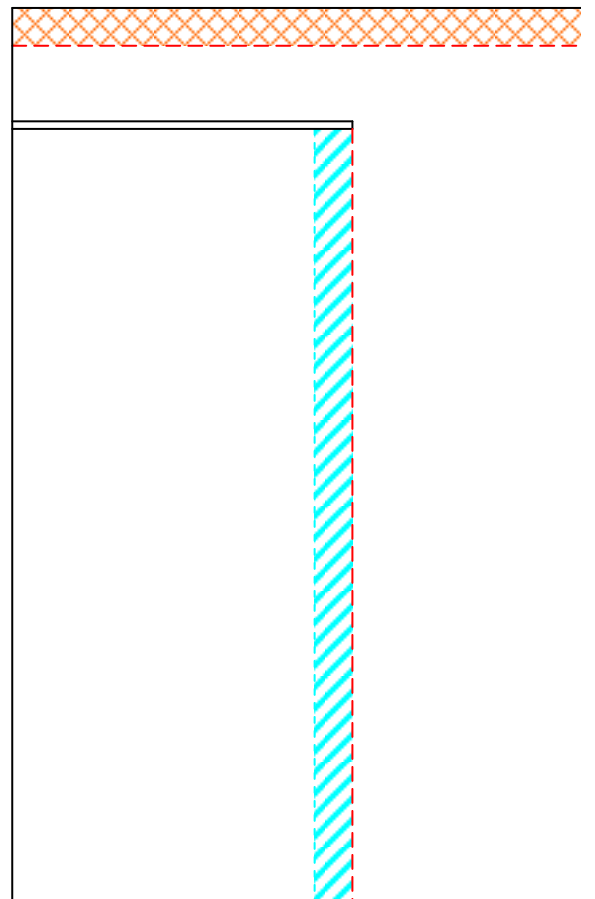
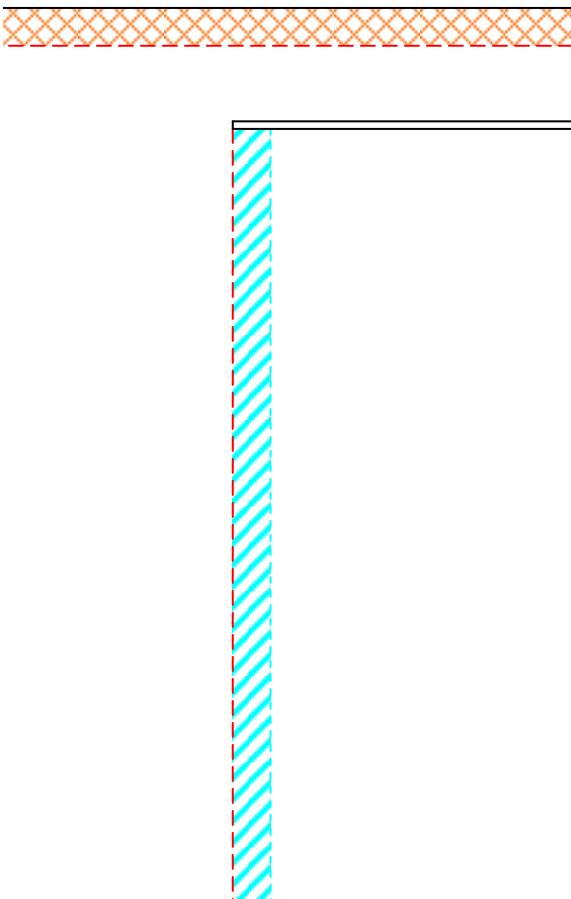

in   
cm

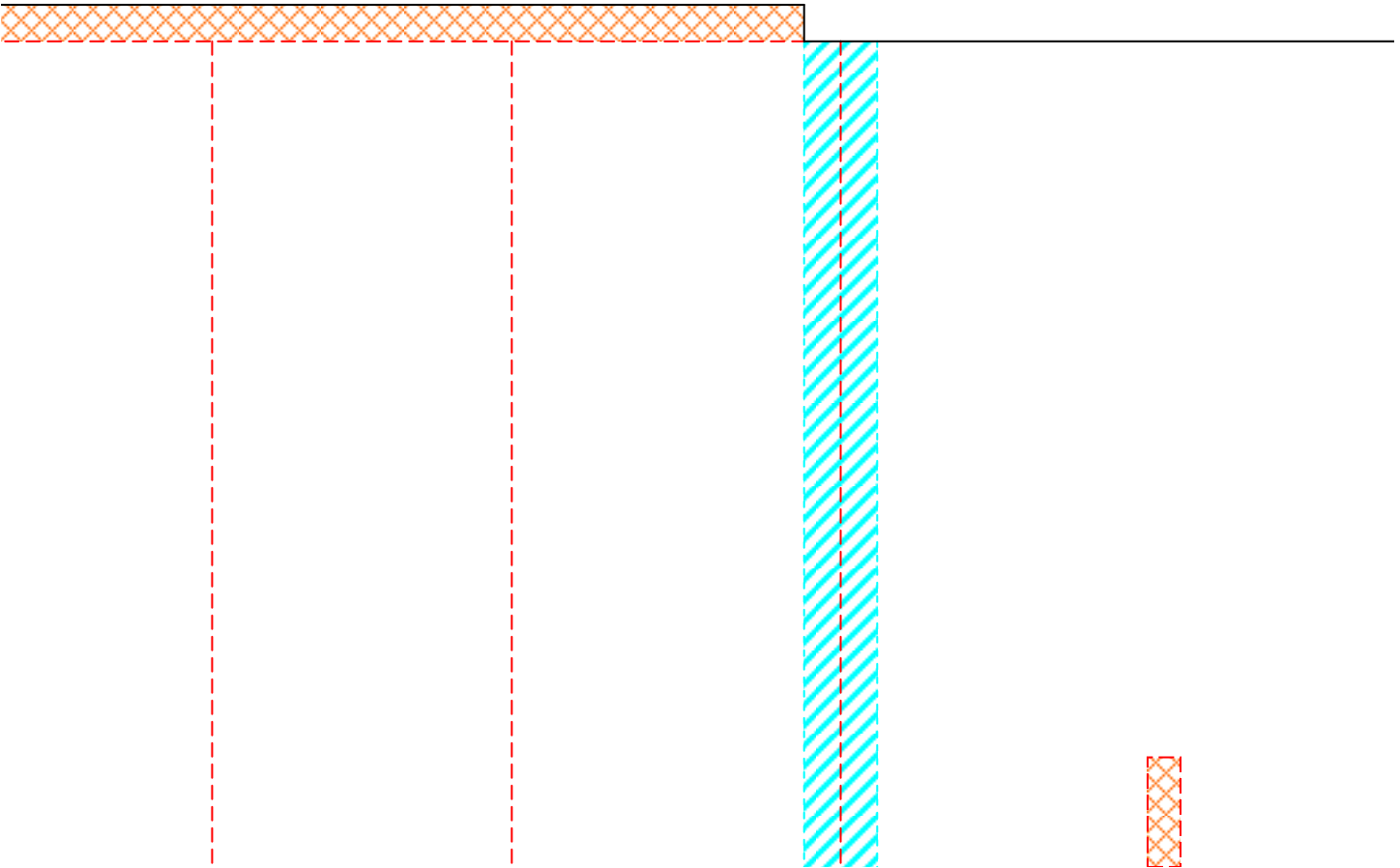

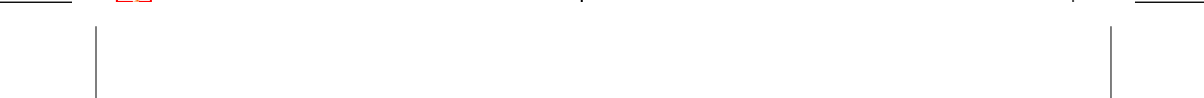
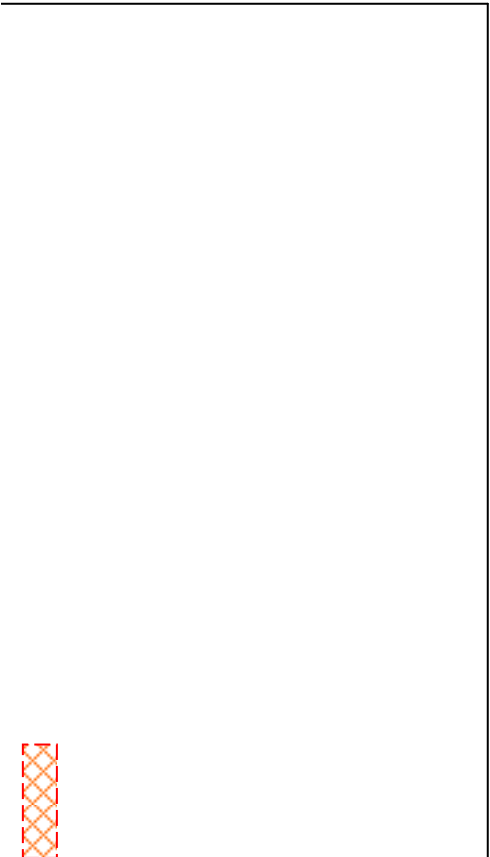
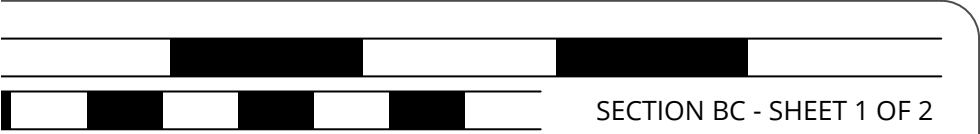

BC1 LEFT WING  
1 FOAM BOARD  
AP GDMA - VERSION 1.0

GLUE PART BCS HERE!



GREEN LINED HOLE



GREEN LINED HOLE

HOLE FOR  
AILERON SERVO

GLUE PART BCG3 HERE!

:S ONLY FOR TWIN ENGINE LAYOUT

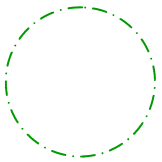

:S ONLY FOR TWIN ENGINE LAYOUT

HOLE FOR  
FLAP SERVO

45° DOUBLE BEVEL



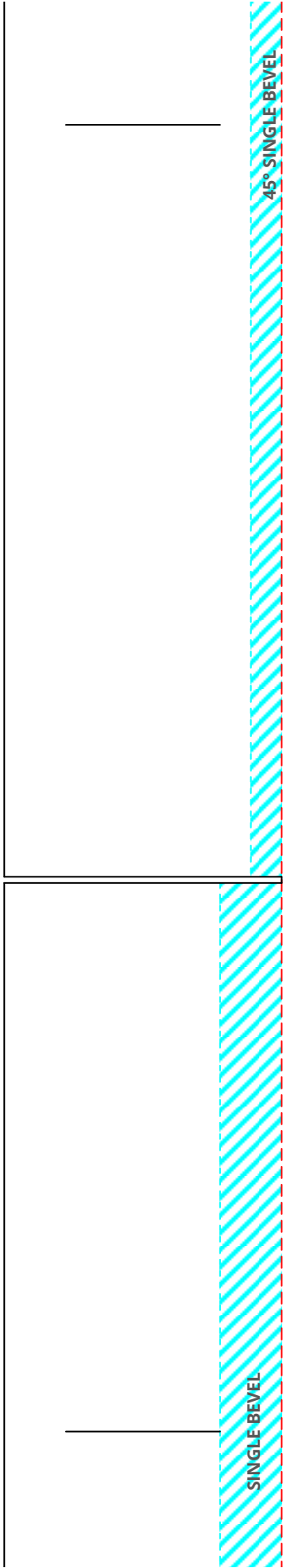
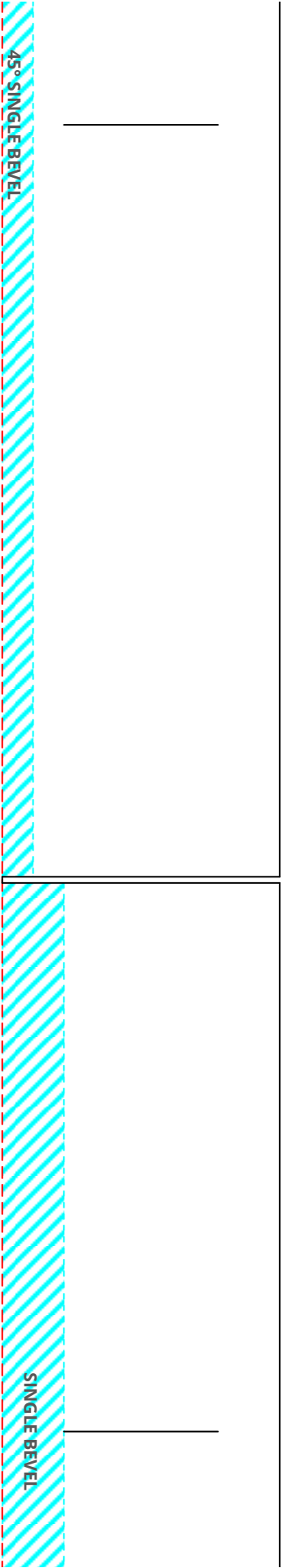





HOLE FOR  
AILERON SERVO

GLUE PART BC4 HERE!



GREEN LINED HOLES ONLY FOR TW

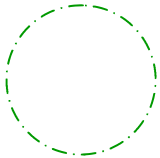

GREEN LINED HOLES ONLY FOR TW

HOLE FOR  
FLAP SERVO

BC2  
1

RIGHT WING  
FOAM BOARD  
AP-GDD04 - VERSION 1.0

IN ENGINE LAYOUT



IN ENGINE LAYOUT



GLUE PART BCS HERE!



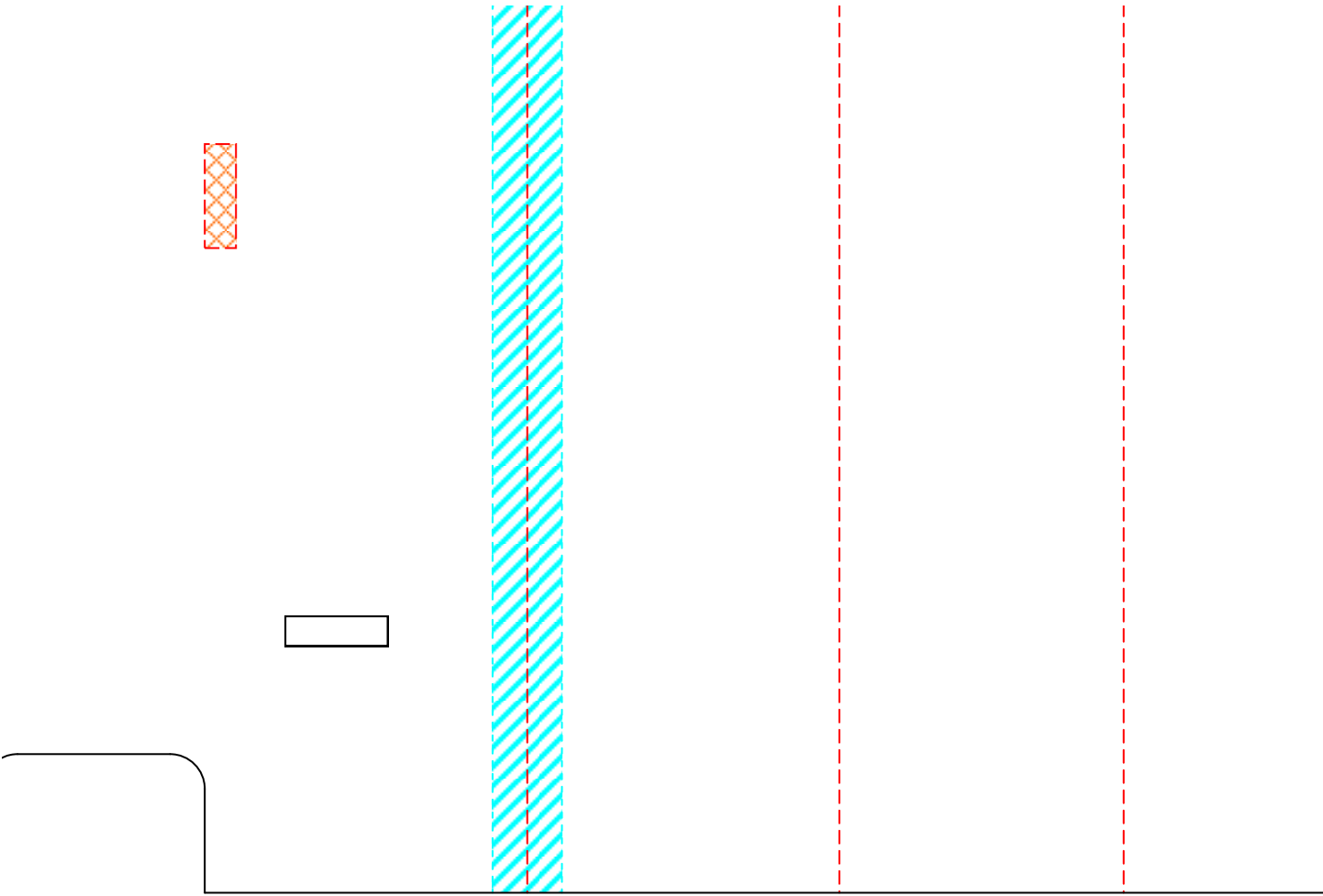

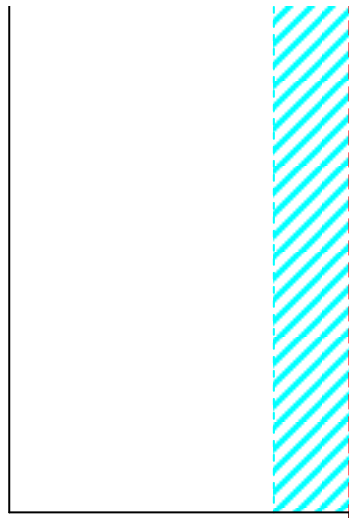
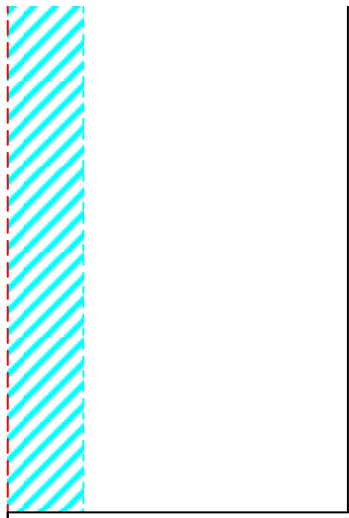

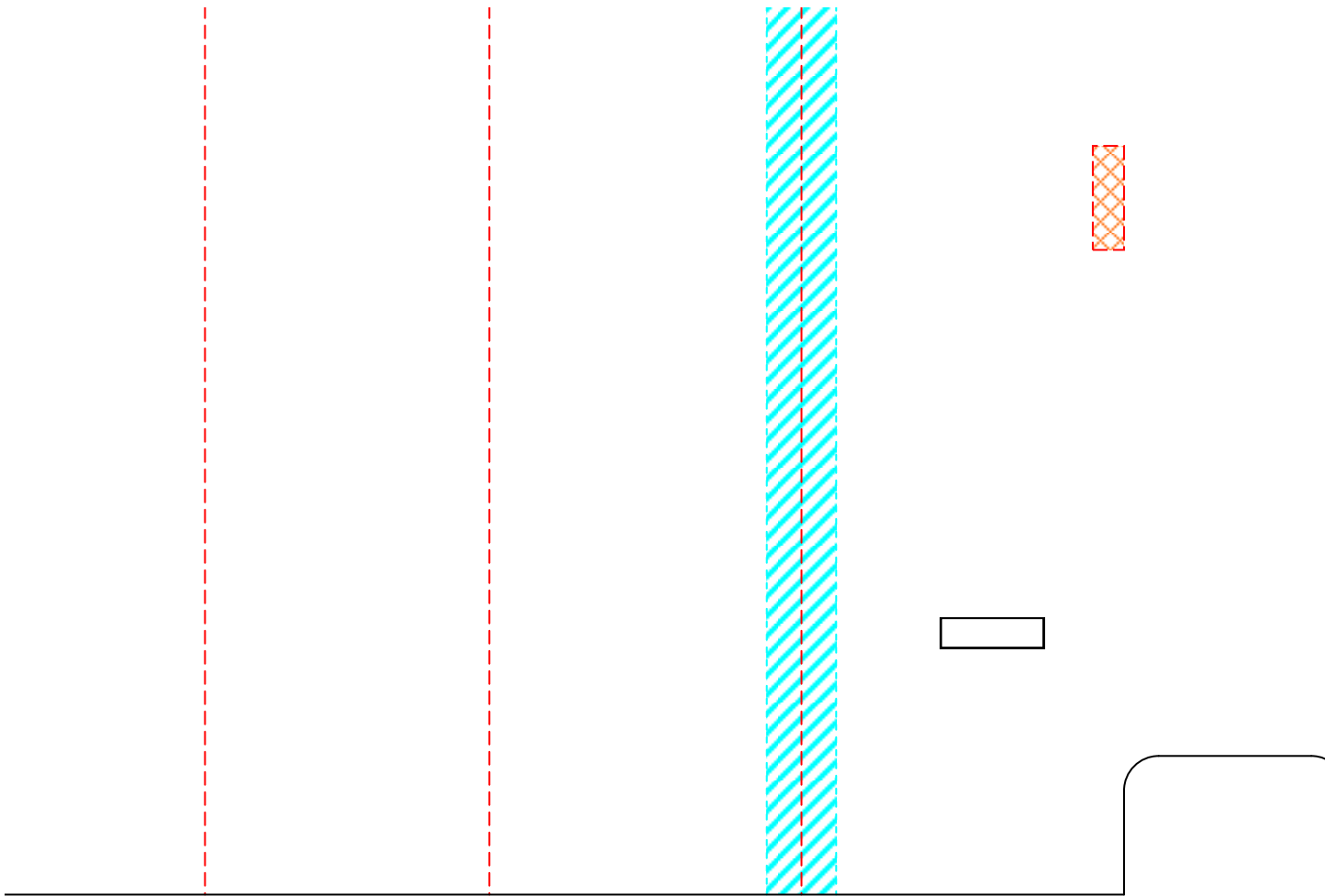

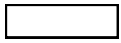

free of charge. Copies allowed for personal use only. Not for commercial use.

# AP Godai - SECTION

Design & Drawing by: Tony Roehling

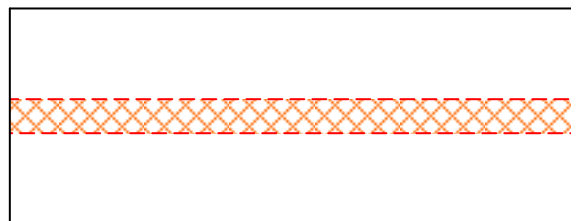
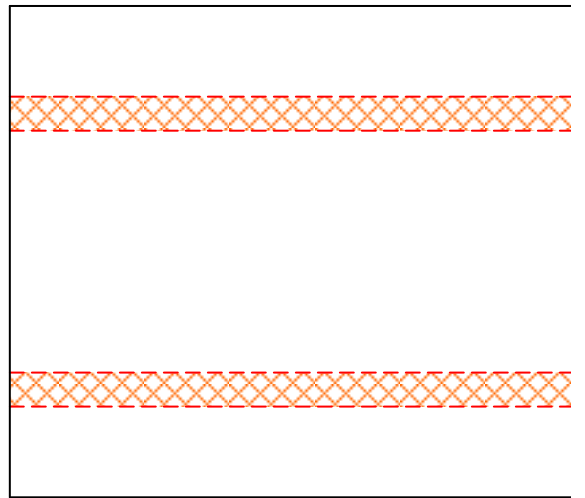



# ON BC - STOL WING - VERSION 1.0 (20

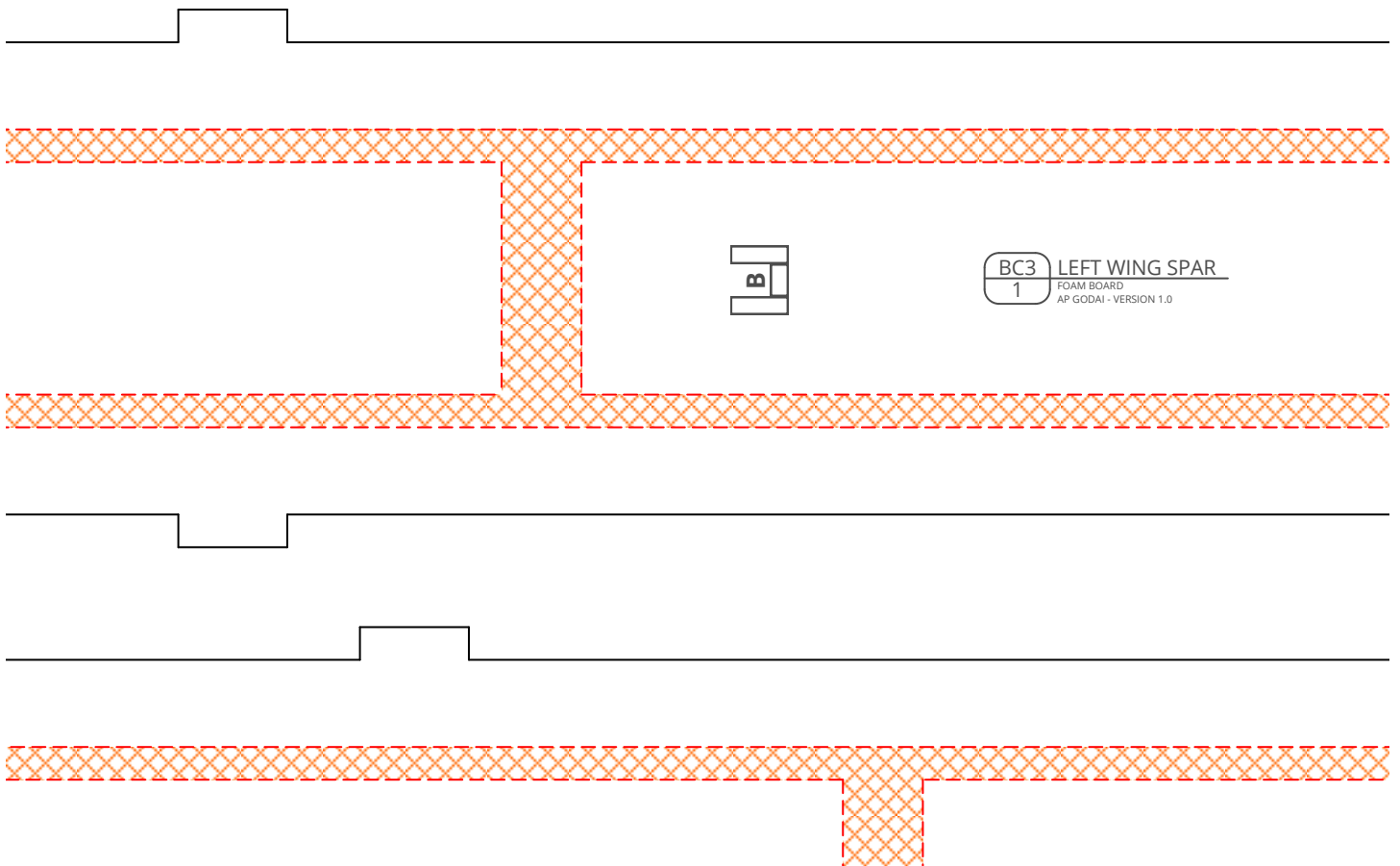

17-08-18)

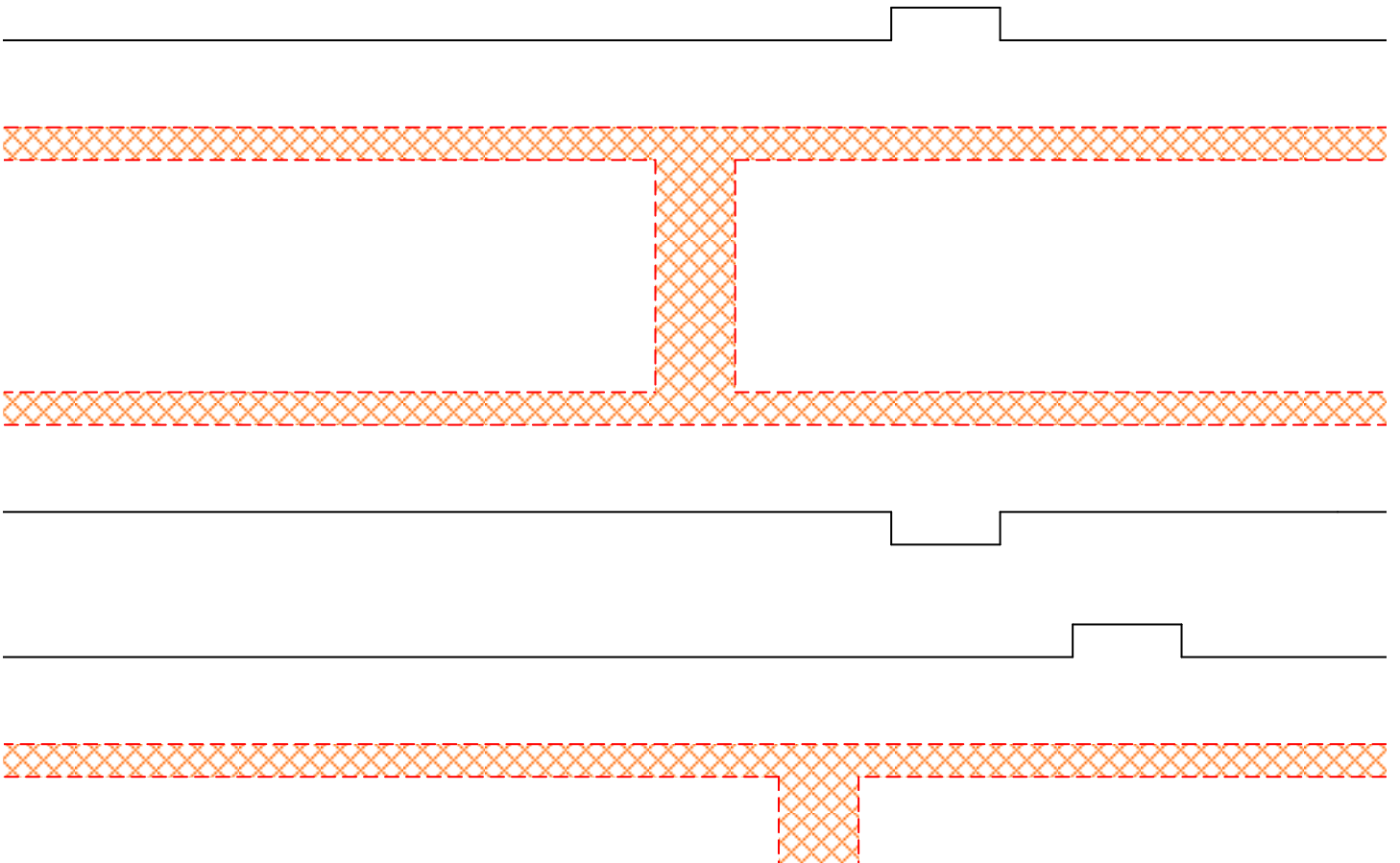

in   
cm 

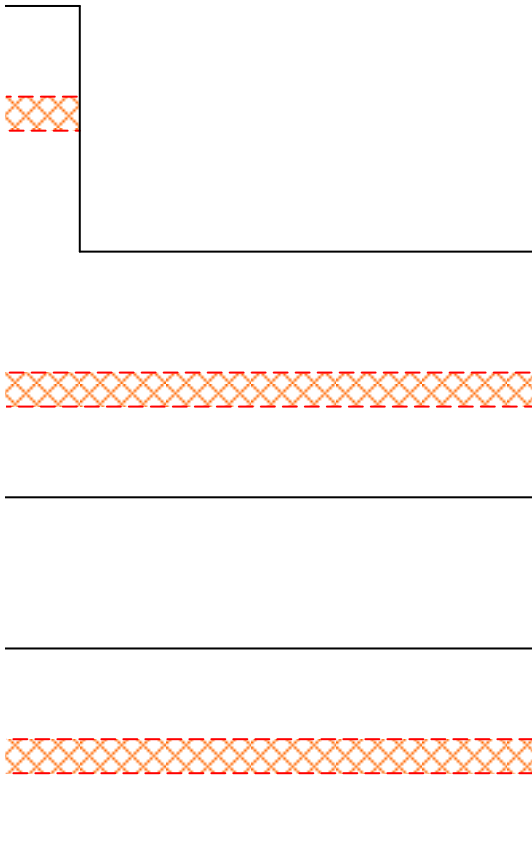

## PARTS MADE OF PLASTIC

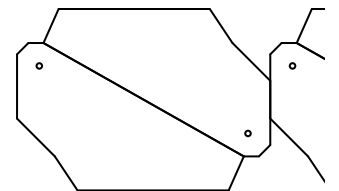

BC8 CONTROL HORN (AILERON)  
4 PLASTIC CARD  
AP GODAI - VERSION 1.0

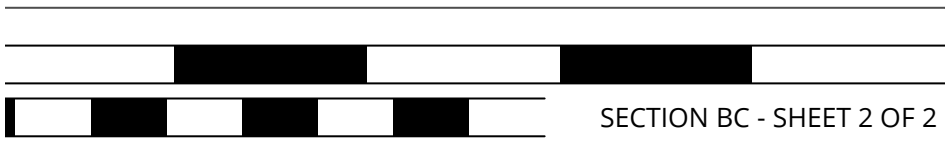

SECTION BC - SHEET 2 OF 2

## STIC CARD

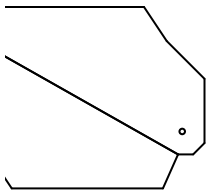

(ONS & FLAPS)





BC5 WING SPACER  
2 FOAM BOARD  
AP.GODAL-VERSION 1.0

BC5 WING SPACER  
2 FOAM BOARD  
AP.GODAL-VERSION 1.0

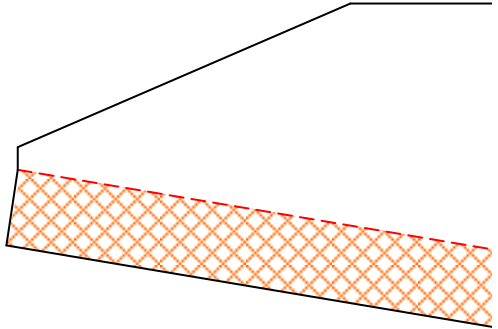



BC4 RIGHT V  
FOAM BOARD  
1 AP GODAI - VEF

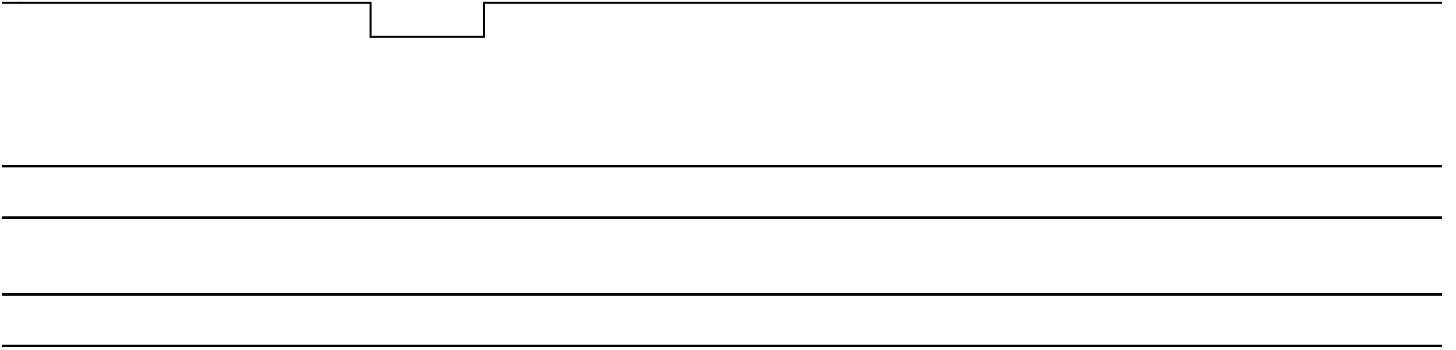
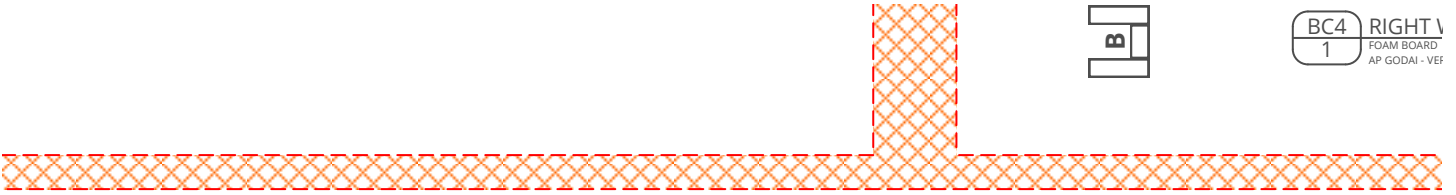

BC7 RIGHT WINGLET  
FOAM BOARD  
1 AP GODAI - VERSION 1.0

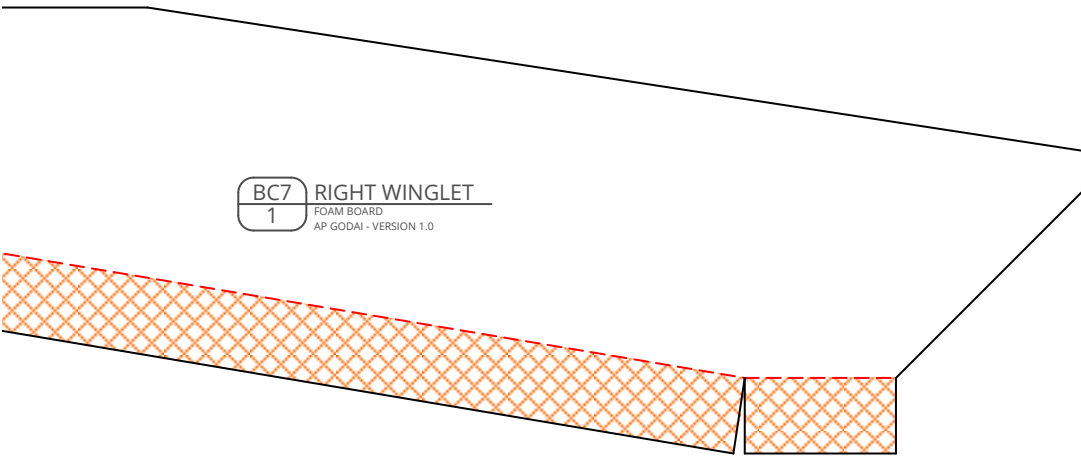

WING SPAR

VERSION 1.0

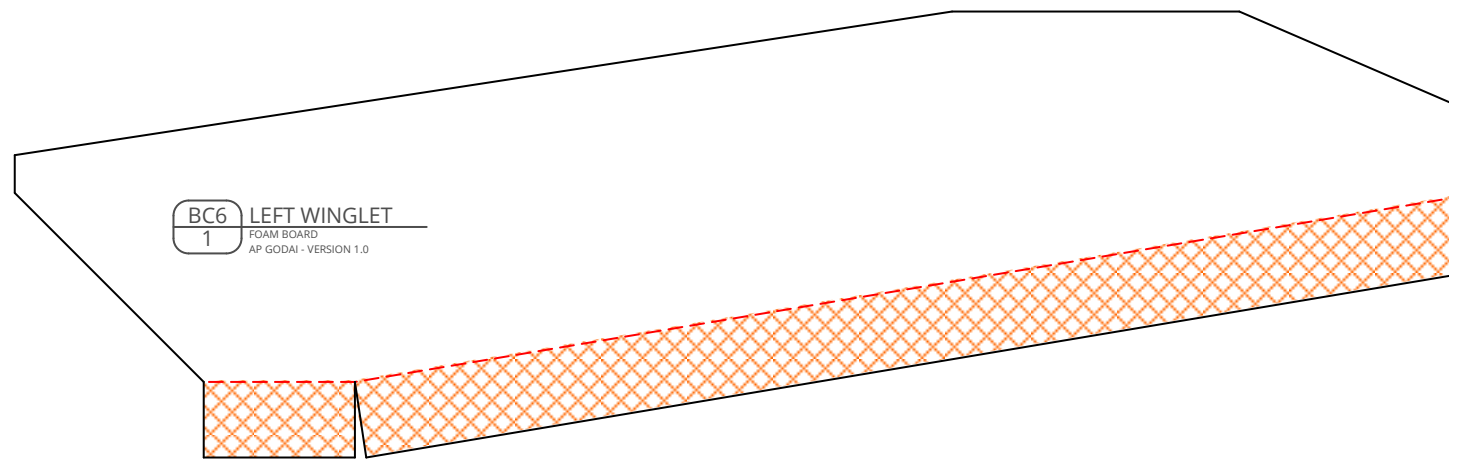
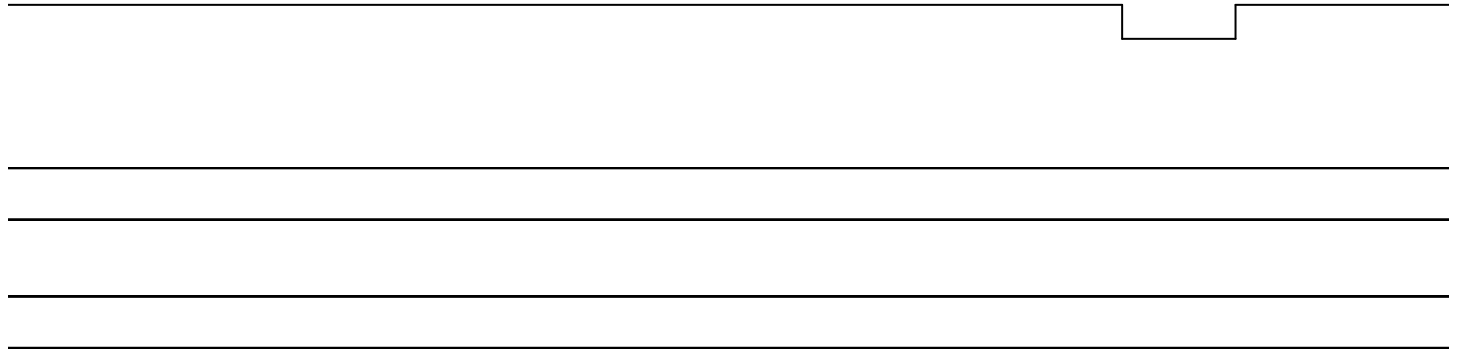
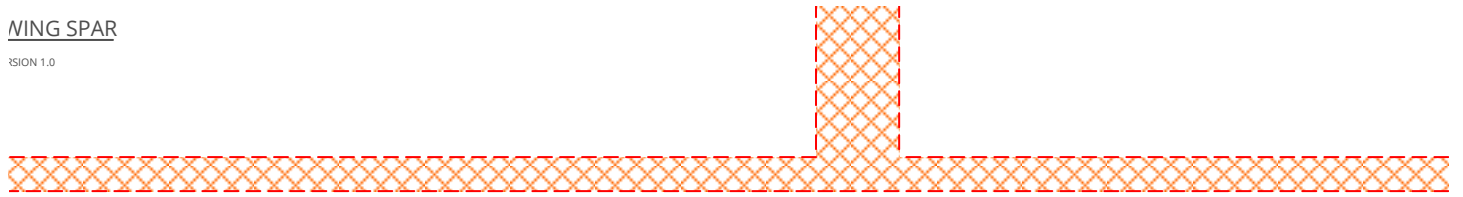

BC6 LEFT WINGLET  
1 FOAM BOARD  
AP GODAI - VERSION 1.0

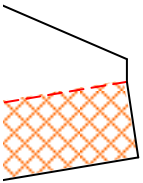
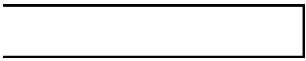







**airc-pirates.com**







free of charge. Copies allowed for personal use only. Not for commercial use.